

**Suspension**

**Springs, High Performance Replacement**

Front	Medium	OME761
Front	Heavy	OME751
Rear	Medium	OME764
Rear	Heavy	OME762
Rear	D110 'soft'	OME752
Rear	D110 heavy	OME755
Rear	Disco 1, extreme duty	OME763

*Defender 90 and Disco 1 the same unless noted*  
 1 -3/16" lift over stock, for up to 110 lbs. extra weight  
 1 -3/8" lift over original height, for up to 240 lbs. extra weight  
 1 -9/16" lift over original height  
 2" lift over original height, 440 lb.constant load  
 smooth ride: good for off road if lightly loaded



Minimum constant load 440 lbs.; 1.26" lift over original (Stiff)

*Heavy duty springs are recommended only when heavy loads are carried continuously. Medium work fine in most cases, and will carry more than stock. Heavy loads equait to (front) ARB bull bar plus winch : (rear) combinations of rear area passengers, roof rack gear including tents, and trailer tongue weight. All 4 springs are different, exactly like factory springs. Please refer to the 'Emu' pages of the 'Off Road' section on our website: britishpacific.com, or call 800 554 4133. We'll make sure you get the right set up!*

**Springs, Stock Replacement** *Coil springs need replacement about every 7 years, or if the truck noticeably leans to one side.*

"Left" refers to driver's side: replacement of old springs will lift the vehicle significantly, back to original height.

Defender 90	Left front	NRC9446
	Right front	NRC9447
	Left rear	NRC9448
	Right rear	NRC9449
Defender 110	Front left	NRC804
	Front right	NRC8045
	Rear left	NRC6388
	Rear right	NRC7000
Discovery	Left front	NRC4306
	Right front	572315
	Rear	ANR3477

blue/white stripe  
 blue stripe  
 both sides the same



**Spring Seats**

Front:	Defender, Disco	NRC9700	all Disco & D110, D90 to mid-'94 (RA939980, mid-'94 on
	D90 from RA939981	ANR3578	
Rear	D90, Discovery lower	NRC9700	
	Disco, upper	ANR2938	

**Shocks, Factory Replacement**

*preserves the original ride, fine for light off road use*

Front	Defender 90	STC3766
	Defender 110	STC3769
	Discovery	STC3703G
Rear	Defender 90	STC3767
	Defender 110	STC2854
	Discovery	STC3704G



**Shocks, Heavy Duty**

(Old Man Emu gas type: strongly recommended when adding OME springs, but also work well with stock)

Front	N45F	
Rear	N46	
Shock tower, front	NRC6372	
Mounting ring, front	572087	uses nuts NH605041L

**Bushings**

Panhard rod	original rubber	ANR3410	2 required per rod
Radius arm to axle,	rubber, D90	NTC6781	2 per arm
	Disco	NTC6860	2 per arm
	D110	NTC7307	2 per arm
Radius arm to frame,	rubber	NRC4514	2 required per arm
Trailing arm bush		NTC9027	set of 2: STC618
Shocks: front, original rubber		8510240	4 per shock
	Rear, original rubber, upper	NRC5593	2 required
	Defender lower	8510240	Up to VA: 2 per shock
	D90 lower, '97only	RNF100090L	automatic models
	Discovery lower	ANR1721	
Sway bar mount bushings, rubber			
Front		NTC6828	2 per bar
Rear D90		EGP1889	2 per bar
Rear D110		NRC5674	2 per bar
Rear Discovery		NTC7394	2 per bar

**Spring Air Boosters**

Add to your rear coil springs for increased load capacity. They inflate like a tire for periodic heavy work with all coil springs.

**Stock springs:**  
 D90: 61741  
 Disco 1: 61758  
 Emu springs: 61737

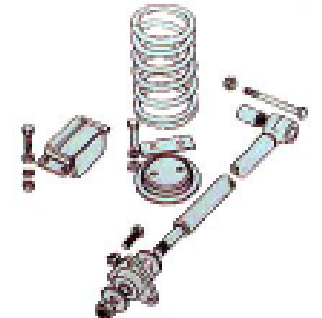

**Complete Polybush Sets**  
 rides like rubber,  
 tough like urethane!

**Full Vehicle Set GAL105  
 HD Defender 90 GAL101**