

**Suspension**

**Front:**

Coil spring, standard	REB101330
Ball joint, upper	FTC3570
Ball joint, lower	FTC3571
nut, for above	NY214043
Panhard rod bushing	ANR3671
Radius arm bushing, to front axle	RBX101680
to chassis	RBX101730
Shock absorber : standard & SLS, no ACE	RNB103533
ACE, non SLS	RNB103683
ACE, with SLS	RNB103694
Shock bushings: upper	ROA100050
lower	ROA100040
Bump stops	RNV100060
Anti sway bar mount bush, std.	RBX101690
ACE	RBX101181
Torsion bar bushing, ACE	RBX101740



**Rear:**

Coil spring, standard	RKB000310
Air spring, SLS	ASRD2
Height sensor	RQH100030
Watts linkage bushings: center	RGW100020
top and bottom	RGX100960
outer links	RGX100970
Rear shocks: standard	RPD102333
ACE, non SLS	RPD102343
ACE, with SLS	RPD102354
Shock bushings, all	ROA100050
Anti roll bar mount bush, rear air springs	RBX101700
rear coil springs	RBX101710
Anti roll bush, ACE, torsion bar end	ANR6551
link end	ANR6554
mount, to frame	RBX101181
Torsion bar bushing, ACE	RBX101740
ACE filter	RVJ100010
SLS filter	RQB000540
ACE fluid	LRN2261

**Steering**

Steering box	QAF000040
Output shaft seal: see diagram	QFW100180
High pressure hose	QEP105481
Low pressure hose	QEP105510
Steering column joint, upper	QLC100090
lower	QLC100110
Tie rod end joint, short	QFS000010
long	QEK000030
complete track rod assembly w . ends	TIQ000010
Steering damper, stock	QHH100001
Emu, gas HD	OMESD02



**Emu spring and shock options, Discovery II**

*Springs are rated by the load they need to carry- all provide about 1.5" of lift over stock height.*

Front:	Light Load	OME776
	Medium Load (to 1 10 lbs.)	OME777
	Heavy Load (to 250 lbs.)	OME779
	Shocks (oleo-pneumatic)	N107
Rear:	Medium Load	OME781
	Heavy Load	OME762
	Heavy Constant Load	OME763
	Shocks (oleo-pneumatic)	N108

*Heavy fronts are for bull bars and winches; heavy rears are for racks with tents or other large loads. Call us for help in selecting springs.*

**SLS Conversion: replace the rear air springs with coils: standard or Emu**

Rear coil springs, Disco II factory stock type: RKB000310 x 2  
 Emu springs: see above, replace as a set of 4  
 Coil spring isolators: ANR2938 x 2  
 Bolts: KYP500250 x 4  
 Spring seat: ANR3578 x 2

**Disco 2 Steering Box Seals**

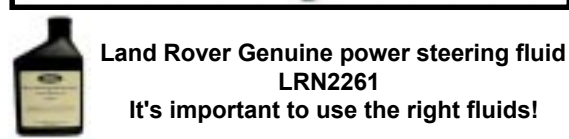
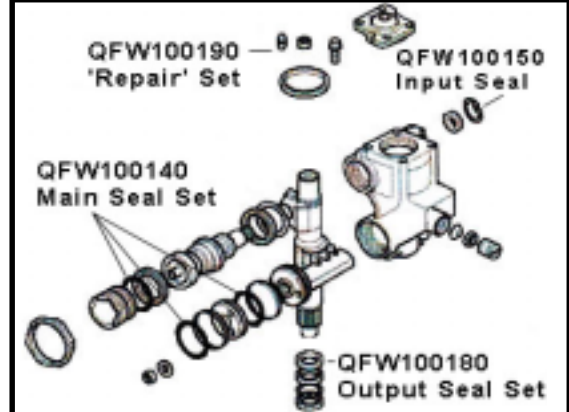

**Land Rover Genuine power steering fluid LRN2261**  
 It's important to use the right fluids!

**Discovery 2 Suspension Terminology**

'Standard' uses plain coils and shocks on all 4 corners.

"ACE", or Active Cornering Enhancement, has levers and a hydraulic system that resists body roll. This system can be found on trucks with 4 coil suspension.

"SLS" stands for Self Levelling Suspension. This feature replaces the rear coil springs with air springs.

Vehicles with ACE may be fitted with Emu springs & shocks. SLS vehicles can be deactivated and converted to coils if desired.