

Clutch Slave Cylinder & Linkage, Series II & IIA

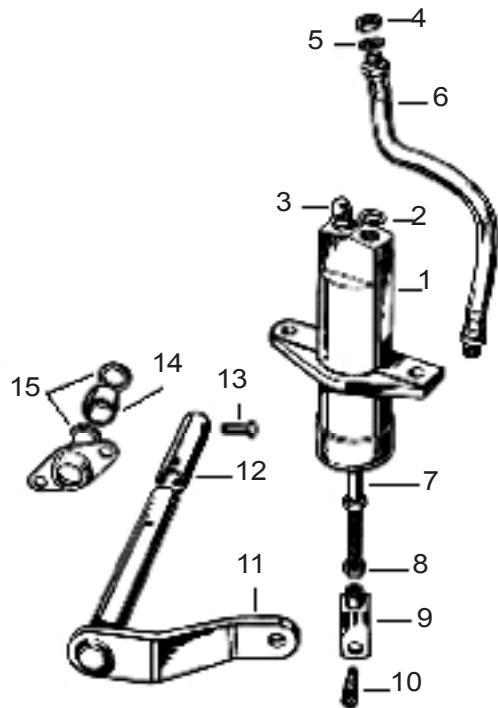

II & IIA clutch releasing near the floor

If the clutch on your Series II or IIA releases close to the floor, you know your clutch cylinders are in good condition and no amount of bleeding helps, chances are very good that your mechanical clutch linkage is worn out and needs replacing.

The mechanical clutch linkage is often one of the most neglected systems on a Land Rover because it just works. Over time and without periodic lubrication the pivot pins become grooved, the spherical bushing wears out, and the holes in the arms become oval. Added up this can translate to a lot of freeplay. The clutch should be released when the pedal is about half way to the floor.

The bronze bushing is porous and should be soaked in oil for 24 hours prior to installation. Be sure to oil the felt washers on either side of the bronze bushing as well.

- | | |
|---------------------------------------|-----------------|
| 1 Slave cylinder (Ser. II & IIA) | 266694, 266694P |
| Rebuild kit | 8G8600L |
| 2 Washer, flex hose | 233220 |
| 3 Bleed screw | 556508 |
| 4 Nut for hose | 254852 |
| 5 Washer, flex hose | 233220 |
| 6 Hose, flexible, II& IIA through '68 | RTC3386 |
| Hose, flexible IIA '69 - '71 | RTC4425 |
| 7 Push rod | 537601 |
| 8 Lock nut (2 req) | NH605041L |
| 9 Clevis for push rod | 275199 |
| 10 Clevis fixing pin | 216421 |
| 11 Operating lever | 537603 |
| 12 Connecting tube | 561661 |
| 13 Pin for connecting tube (2 req) | 536803 |
| 14 Spherical bush, bronze | 90217984 |
| 15 Felt ring (2 req) | 217985 |

Throw Out Bearing & Linkage, Series II, IIA

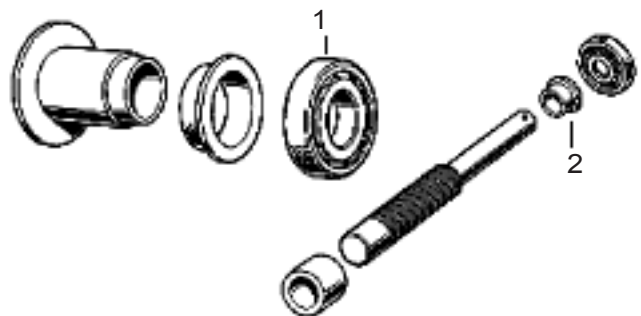

- | | |
|----------------------|----------|
| 1 Bearing, throw out | STC1130 |
| 2 Seal, cross shaft | 90214787 |

- Rubber boot** Seals bell housing cross shaft opening
 Boot for cross shaft (Ser. II, IIA) 553262