

Transmission

26

Note: We need to know the 'suffix' letter when you order transmission parts. It is stamped on the right side of the gear selector cover at the top of the main case. There will be a serial number and a letter stamped behind or below the number. Transmissions produced prior to 1960 are suffix A without a stamped suffix letter. We can not rely upon the model year because the transmission may not be original.

Transmission Series II, IIA

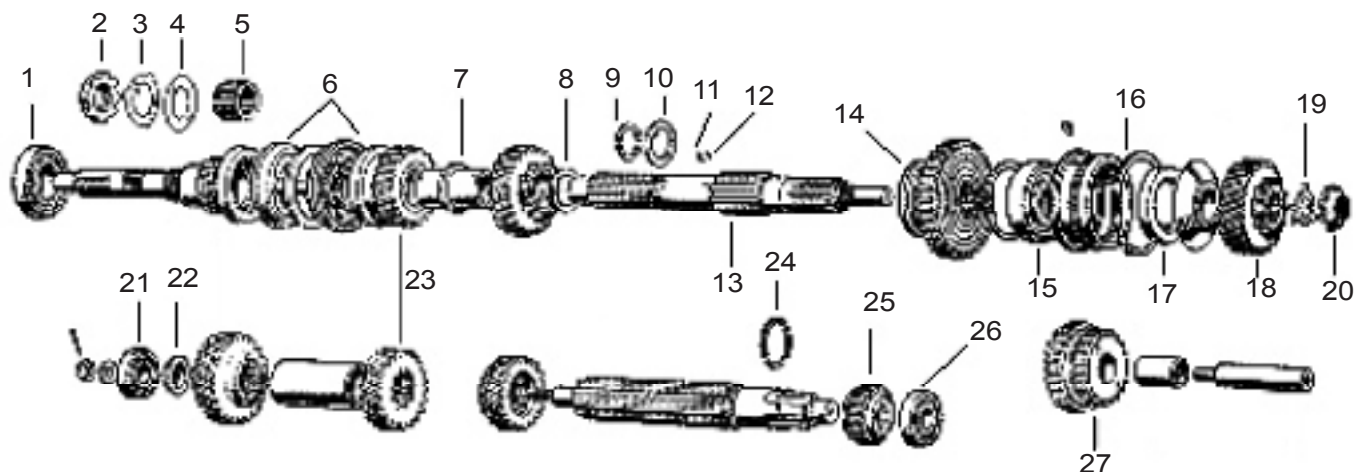

1	Bearing, input shaft	55714	12	Pin, thrust washer	6405
2	Lock nut (fixes bearing to shaft)	213416	13	Main shaft	264250
3	Lock tab	RTC1963	14	1st gear (suffix A & B)	501616
4	Washer	RTC1954		1st gear (suffix C & newer)	511205
5	Roller bearing, input shaft	6397	15	Bearing, main shaft	1645
6	Synchro assy. (3rd & 4th gears)	FRC1758	16	Circlip	RTC1984
7	Distance sleeve	FRC4076 & FRC4077	17	Oil seal, transmission to transfer case	236305
	(2 parts now replace single piece sleeve: use both)		18	Gear, Main shaft output	218244
8	Thrust washer for second gear		19	Lock washer	217476
	.125"	267572	20	Nut	217477
	.128"	267573	21	Bearing, front lay shaft (suffix A)	576207
	.130"	267574		Bearing, front lay shaft (suffix B & on)	528701
	.135"	267575	22	Distance piece, lay shaft (suffix B & newer)	
9	Locking ring, main shaft	RTC1957		.445"	528722
10	Thrust washer for third gear		23	3rd gear pair	245767
	.125"	RTC1962	24	Retainer, lay shaft (suffix A, B, C)	239272
	.128"	STC1118	25	1st gear, lay shaft (suffix A & B)	501616
	.130"	50703		1st gear, lay shaft (suffix C & newer)	511189
	.135"	231737	26	Bearing, rear lay shaft	RTC1412
11	Pin, main shaft distance sleeve	RTC1979	27	Gear, reverse (suffix A & B)	90217389
				Gear, Reverse (suffix C & newer)	561960