

## Hardware

### Sliding window latch

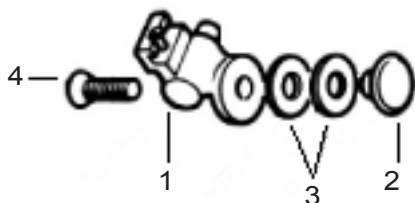

- |  |        |
|--|--------|
| 1 Latch with pin, forward window       | 332324 |
| Latch with pin, rear window            | NLA    |
| 2 Disc nut                             | 332329 |
| 3 Rubber washer (inside latch spacers) | 340391 |
| 4 Screw, forward window                | 78402  |
| Screw, rear window                     | 78401  |

### Hard top mounting studs

One is required at each corner. Rubber buffer required.

- |               |           |
|---------------|-----------|
| 88            | 338741    |
| 109           | MRC9833   |
| Nut for above | NH605041L |



### Rubber buffer



Sits on top of the hard top mounting stud welded washer and under the mounting flange of the hard top. Also sits under each of the hard top's side mounting flanges.

- |  |        |
|--|--------|
| Rear corner buffers (2 req)  | NLA    |
| Front corner and side mount buffer (88, 109 SW - 4 req, 109 regular - 6 req) | 338550 |



## Tech Tip

### Sliding window latch

The latch slides along the steel slide above the window and the pin locks the window at hole locations on the slide. If the latch is cocked in relation to the slide, the pin will not release easily and the latch will not move easily. Use rubber washers, 340391, as needed for spacers between the latch and window to properly align the latch to the slide.



1960 Land Rover 109 with full canvas top



## Tech Tip

### 'Training' a canvas top

After you install your new canvas top, wet the top down and let it dry several times with the sides and back fully secured. The top will shrink to form itself to your vehicle and hoop set. If the sides or back are loose during the initial wet and drying cycles they will shrink unevenly and you will end up with a poor fit.